

SPECIFICATION

Lamp type	LED
Finish	RAL 9003(White)
Materials	Mild Steel
Weight	Recessed Max = 1.5kg Surface Max = 1.9kg.
Supply	220-240V AC, 50/60Hz
Operating temp	0-30C
Connection	Recessed: 6-pole Wieland plug Surface: Piano key terminal block max 2.5mm ² cable
Ingress protection	IP20

Please note: These luminaires are a component part of a lighting control system that requires both additional equipment as well as programming. The maximum distance between fittings or a 2.4GHz low-energy gateway is 8 metres. For full details please contact Whitecroft technical support.

FLORIN EMERGENCY LED TEST

DALI /Self-test luminaire local bi-colour LED indicator status

Green LED	Permanently on	System OK/mains operation mode
	Slow flash	Duration test/commissioning
	Fast flash	Function test
Red LED	Permanently on	LED luminaire fault
	Slow flash	Battery/test failure
	Fast flash	Battery charging failure

Slow flash – a flash every 2 seconds, Fast flash – a flash every 0.5 seconds.

Note that start times of the tests are set automatically to ensure random testing of the units. As a consequence, tests may occur at any time, and caution should be exercised in situations where this may be inconvenient, such as hotels and hospitals.

FLORIN EMERGENCY LED ORIENTATION

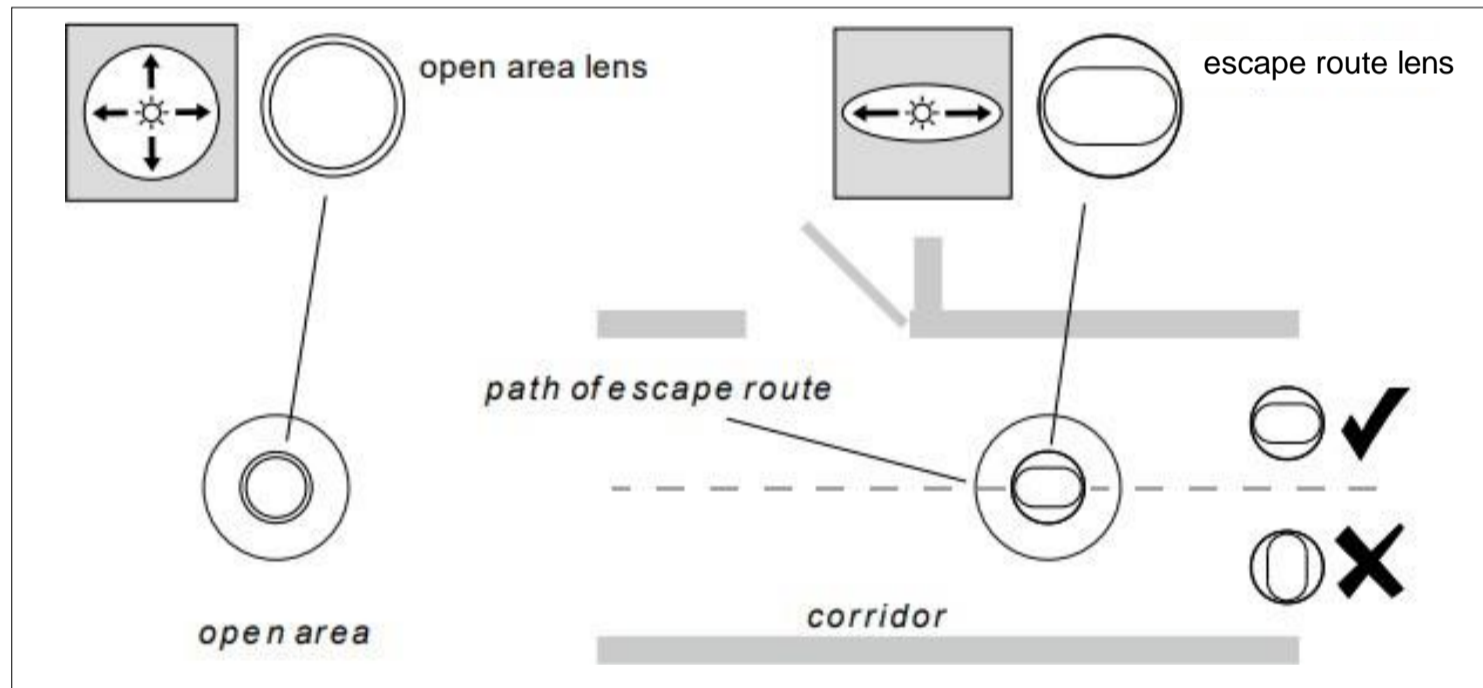

For best photometric performance ensure that the long axis of the escape route lens is in line (parallel) with the path of the escape route as shown above.

GENERAL INFORMATION

1. A qualified electrician, in accordance with IET wiring regulations should carry out connection to mains wiring.
2. Observe ESD precautions during installation.
3. This surface mount unit must be EARTHED. The recessed fitting does not require an earth.
4. Ensure that the rated voltage and frequency requirements are compatible with the available mains supply.
5. Cleaning of reflectors and lenses should be carried out using clean, soft and lint free cloths and anti-static cleaning fluid.
6. Do not carry out high voltage insulation test, i.e. 500/1000v this may damage internal components.
7. The light source contained in the luminaire shall only be replaced by the manufacturer, their service agent or a similarly qualified person.
8. Batteries must only be replaced by a qualified electrician once they fail to meet the required duration.
9. Luminaire must be isolated before commencing any necessary maintenance work or battery connection.

TECHNICAL SUPPORT

Telephone: 0161 330 6811

Email: technical@whitecroftlight.com

<http://whitecroftlighting.com/>



**FLORIN E3
OR3**



Installation Instruction

PK-LEAFLETFLOR3

December 2024 - Rev G



Whitecroft Lighting Limited

Burlington Street, Ashton-under-Lyne, Lancashire OL7 0AX
 Telephone +44 (0)161 330 6811 Facsimile: +44 (0)161 331 5855
 Registered No. 3848973 England Registered Office: As above



Whitecroft Lighting Limited

RECESSED MOUNT - PREPARATION

A Ø115 +/- 1mm hole should be cut in the ceiling prior to installation. This product is suitable for ceiling thicknesses of 10-25mm. Where installing into thin or soft ceiling tiles, an additional pattress may be required. This should be a support panel, to be fitted behind the ceiling, cut from suitable sheet material with a hole drilled to match the luminaire cut aperture. The minimum ceiling void is 175mm based on 10mm ceiling tile. The gear tray has holes for secondary suspension which should be used to retain it during install or when removing.

Part Codes:
FLE32LEP/RG3
FLE31LEP/RG3
FLH31LEP/RG3

Care should be taken during install and removal as the springs are under a lot of tension when loaded.
Gloves should be worn at all times.
Do not connect batteries until there is a reliable permanent mains supply present as a mains interruption will reset the commissioning test clock.

INSTALL

1. Remove product from packaging and check for damage.
2. Wire 6-pole female plug to incoming supply (Fig.1).
3. Bring female plug through cut aperture and connect to male plug attached to product.
4. Connect battery and Florin LED head and fill in the commissioning date on the label.
5. Feed gear units through aperture and rest on back of ceiling.
6. Insert fascia plate using springs. Bend both springs at the same time before fitting into the aperture. Be careful especially on thin or soft ceilings. When springs are sufficiently through aperture the fitting will be pulled through rapidly.
7. FLE32/RG3 has an escape route / corridor lens so fitting may route / corridor lens so fitting may have to be rotated in ceiling. See Florin Setup on back page.

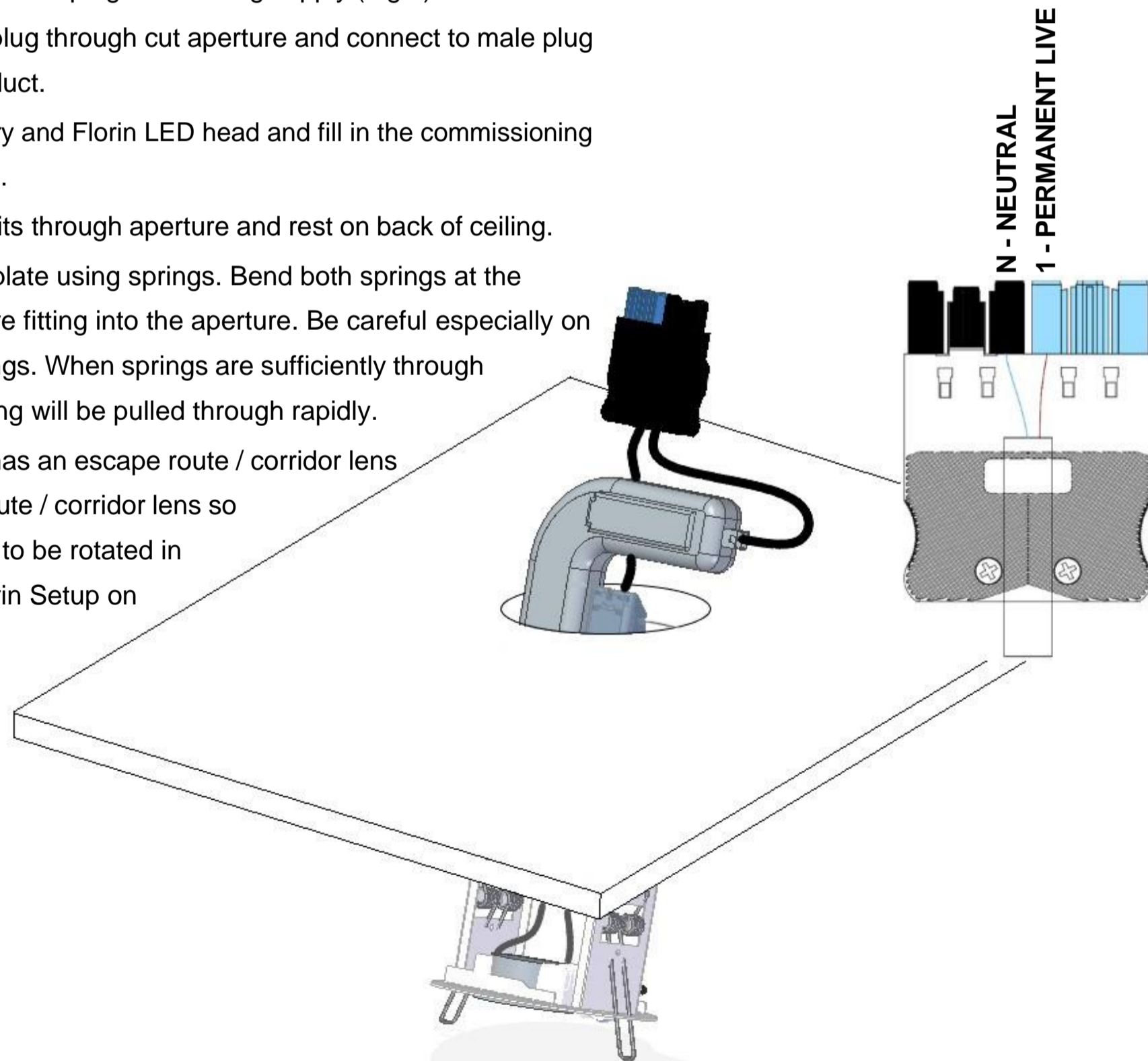

FIG. 1 FEMALE PLUG



Whitecroft Lighting Limited

SURFACE MOUNT - PREPARATION

Product is not suitable for conduit mounting. Side entry should be via a hard cable gland.

Part Codes:
FLSE32LEP/RG3
FLSE31LEP/RG3
FLSH31LEP/RG3

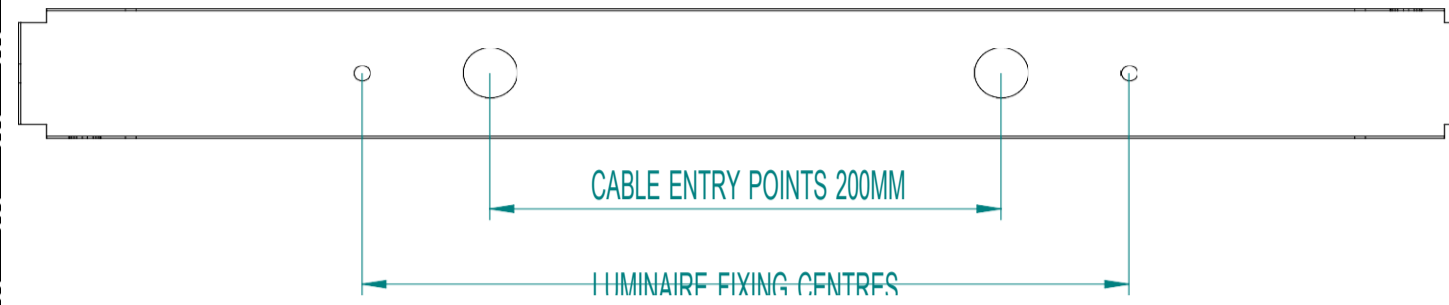

SUPPLY CABLE STRAIN RELIEF POINTS

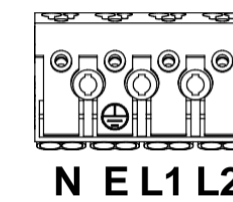
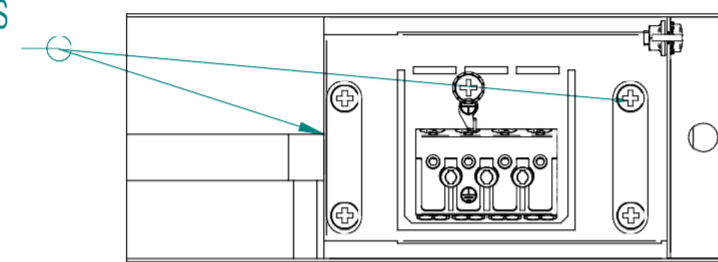

N- NEUTRAL
 E- EARTH
 L/L1- SWITCHED LIVE
 L2- PERMANENT LIVE

FIG.2 MAINS TERMINAL BLOCK

HOLES FOR SAFTY CORDS

EARTH TAB

SIDE CABLE / CONDUIT ENTRY

1. Remove product from packaging and check for damage.
2. Remove ceiling bracket from gear box via M5 screws and detaching safety cords and earth.
3. Screw ceiling bracket to surface using appropriate fixings - supplied by others. Please note FLSH31/RG3 has an escape route / corridor lens so fitting should be orientated with long edge parallel to corridor or escape route. See Florin Setup on back page.
4. Attach safety cords.
5. Attach earth lead from gear box to ceiling bracket.
6. Bring incoming supply through cable entry points on side or top and wire into terminal block (Fig. 2) using strain relief clamps to secure flex.
7. Re-attach gear box to ceiling bracket ensuring all cables are tucked inside.

