

General Information

1. A qualified electrician, in accordance with IET wiring regulations should carry out connection to mains wiring.
2. Luminaire must be isolated before commencing any necessary maintenance work or battery connection.
3. Ensure that the rated voltage and frequency requirements are compatible with the available mains supply.
4. Do not carry out high voltage insulation test, i.e. 500/1000v this may damage internal components.
5. The light source contained in the luminaire shall only be replaced by the manufacturer or a designated service agent or a suitably qualified person.
6. Batteries must only be replaced by a qualified electrician once they fail to meet the required duration.
7. Dali control cables must be double insulated & have an equivalent rating to the supply cable if applicable.
8. Ensure ceiling is of sufficient strength to support luminaire - Fit secondary suspension where necessary.
9. Observe ESD precautions during installation.
10. All luminaires must be EARTHED. (Excluding Class II luminaires).
11. Do not cover recessed luminaires with any thermally insulating materials.
12. Do not use the wire suspension to raise or lower the luminaire. (See full instructions for further details.)

Product Specification

Lamp Type	LED
LED Colour	4000K/ 3000K
Control gear	DALI
Emergency	Intergral 3hr / COMEPS / Routefinder Wireless
Finish	White / Black / Silver
Materials	Polycarbonate / Aluminium / Mild Steel
Weight 1200mm	Narrow 4.8kg / Wide 5.7kg
Weight 1500mm	Narrow 5.5kg / Wide 7.2kg
Emergency Weight 1200mm	Narrow 5.3kg / Wide 6.2kg
Emergency Weight 1500mm	Narrow 6kg / Wide 7.7kg
Supply	220-240V 50/60Hz
Cable entry	20mm and 16mm
Connection	0.5-2.5mm ²
Ingress protection	IP40 Surface and Suspended, IP20 Side Conduit
Impact protection	N/A
Temperature range	0-35°
Ceiling Compatibility	Surface, Suspended and Side Entry Conduit Only
Suspension Detail	2x Single Point Y suspension

Full Installation Instructions

Scan QR code below:



Product Dimensions

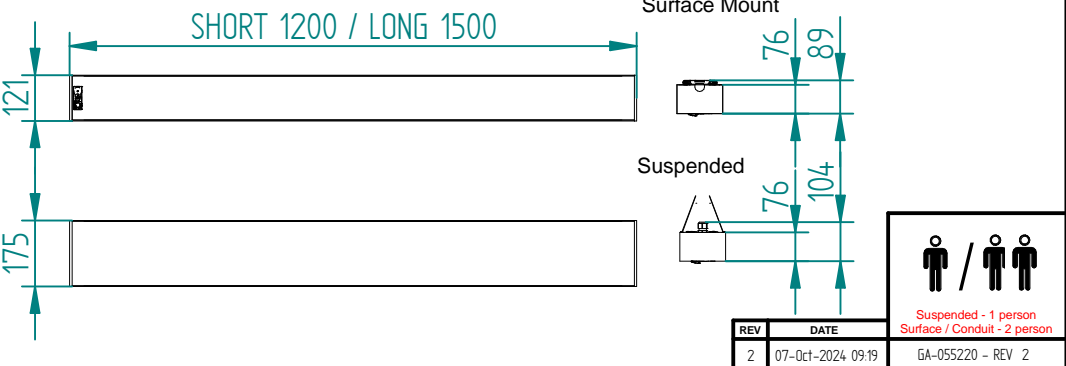

Whitecroft Lighting Limited
 Burlington Street,
 Ashton-under-Lyne,
 Lancashire OL7 0AX

Technical Support
 0161 330 6811
 technical@whitecroftlighting.com
 http://www.whitecroftlighting.com

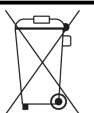

General Information

1. A qualified electrician, in accordance with IET wiring regulations should carry out connection to mains wiring.
2. Luminaire must be isolated before commencing any necessary maintenance work or battery connection.
3. Ensure that the rated voltage and frequency requirements are compatible with the available mains supply.
4. Do not carry out high voltage insulation test, i.e. 500/1000v this may damage internal components.
5. The light source contained in the luminaire shall only be replaced by the manufacturer or a designated service agent or a suitably qualified person.
6. Batteries must only be replaced by a qualified electrician once they fail to meet the required duration.
7. Dali control cables must be double insulated & have an equivalent rating to the supply cable if applicable.
8. Ensure ceiling is of sufficient strength to support luminaire - Fit secondary suspension where necessary.
9. Observe ESD precautions during installation.
10. All luminaires must be EARTHED.(Excluding Class II luminaires).
11. Do not cover recessed luminaires with any thermally insulating materials.
12. Do not use the wire suspension to raise or lower the luminaire. (See full instructions for further details.)
13. Luminaire suspension wires should only be adjusted with luminaire supported & under no load.



Suspended - 1 person
Surface / Conduit - 2 person

REV	DATE
2	07-Oct-2024 09:19

GA-055220 - REV 2

Whitecroft Lighting Limited
Burlington Street,
Ashton-under-Lyne,
Lancashire OL7 0AX

Technical Support
0161 330 6811
technical@whitecroflighting.com
<http://www.whitecroflighting.com>

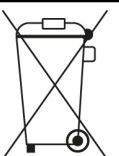

Product Installation Instructions

1 MOUNTING DETAILS

All dimensions are in millimeters (mm)

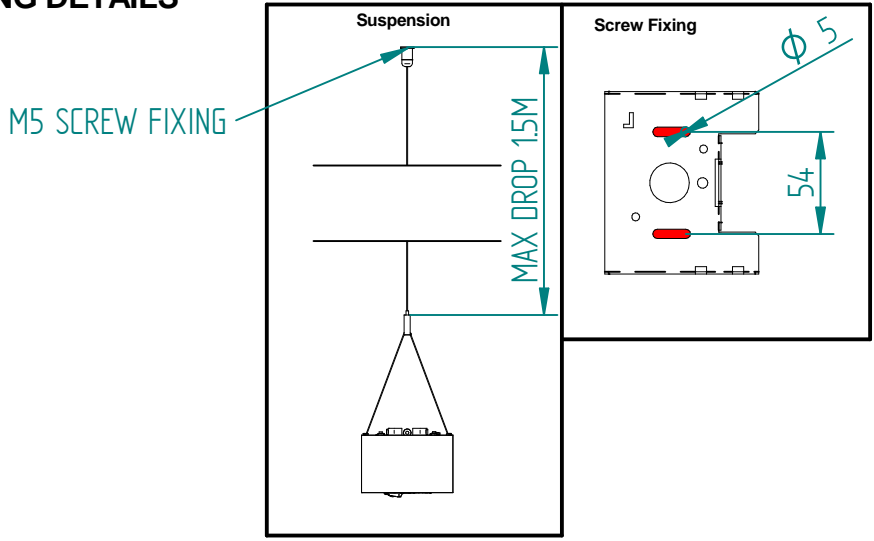

Suspended Product - Fixing centres range

NOTE: DIFFERENT DIMENSIONS FOR SHORT AND LONG VERSIONS. DIMENSIONS ARE RECOMMENDED FOR CABLE ENTRY BUT THERE IS FLEXIBILITY IN THE DESIGN.

Surface Product - Fixing centres range

NOTE: DIFFERENT DIMENSIONS FOR SHORT AND LONG VERSIONS. DIMENSIONS ARE RECOMMENDED FOR CABLE ENTRY BUT THERE IS FLEXIBILITY IN THE DESIGN.

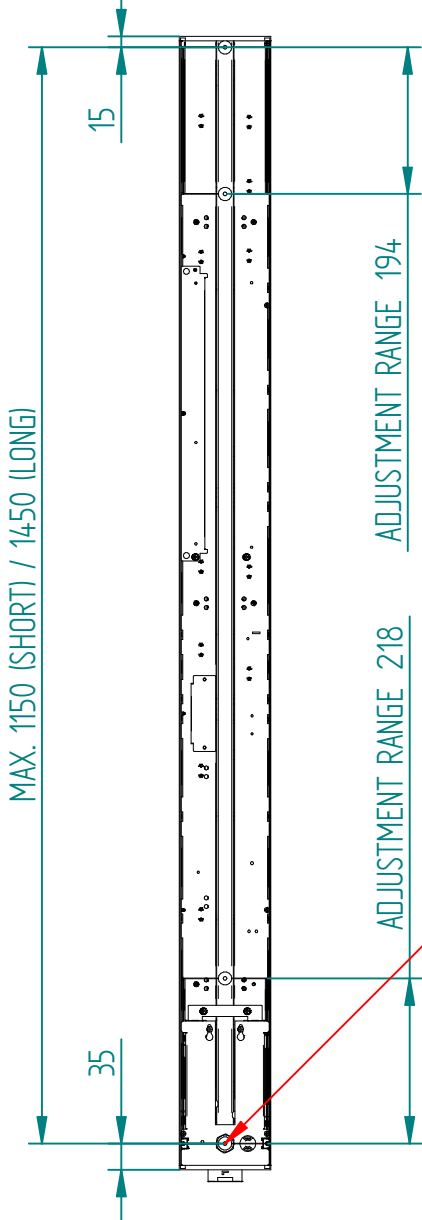

RECOMMENDED CABLE ENTRY IN CEILING DIRECTLY ABOVE FITTING CABLE ENTRY POINT

SIDE CONDUIT VERSION

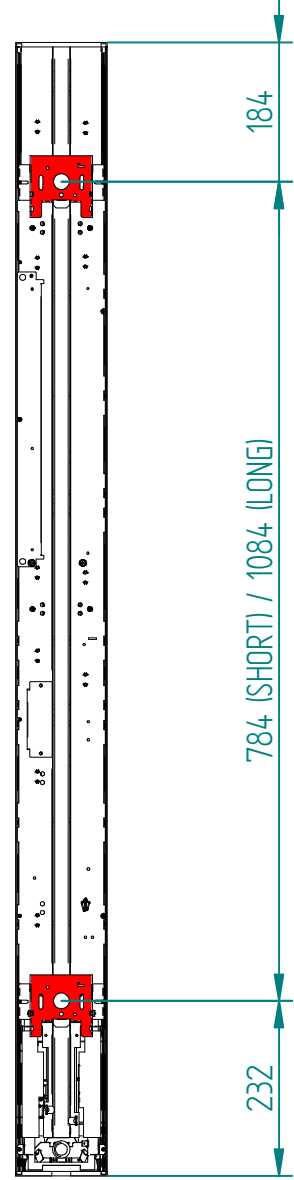
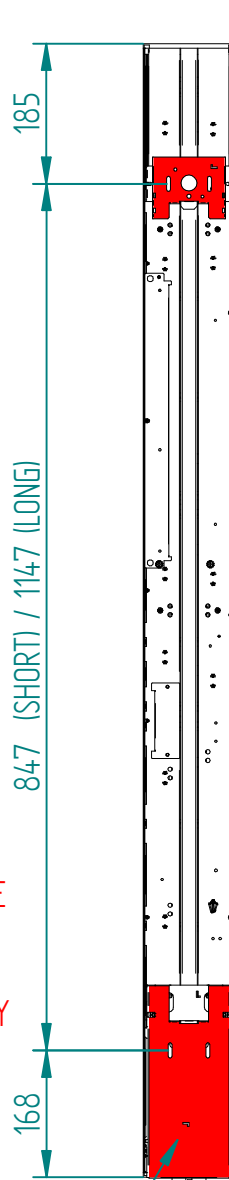

Product Installation Instructions

- 2 REMOVE PACKAGING AND INSPECT PRODUCT FOR ANY DAMAGE.
LOCATE SUSPENSION, SURFACE (REAR MOUNT) OR SURFACE (SIDE ENTRY) KIT.**
- 3 FIX THE SURFACE MOUNT BRACKETS OR SUSPENSION CABLES TO CEILING USING PREFERRED METHOD.**

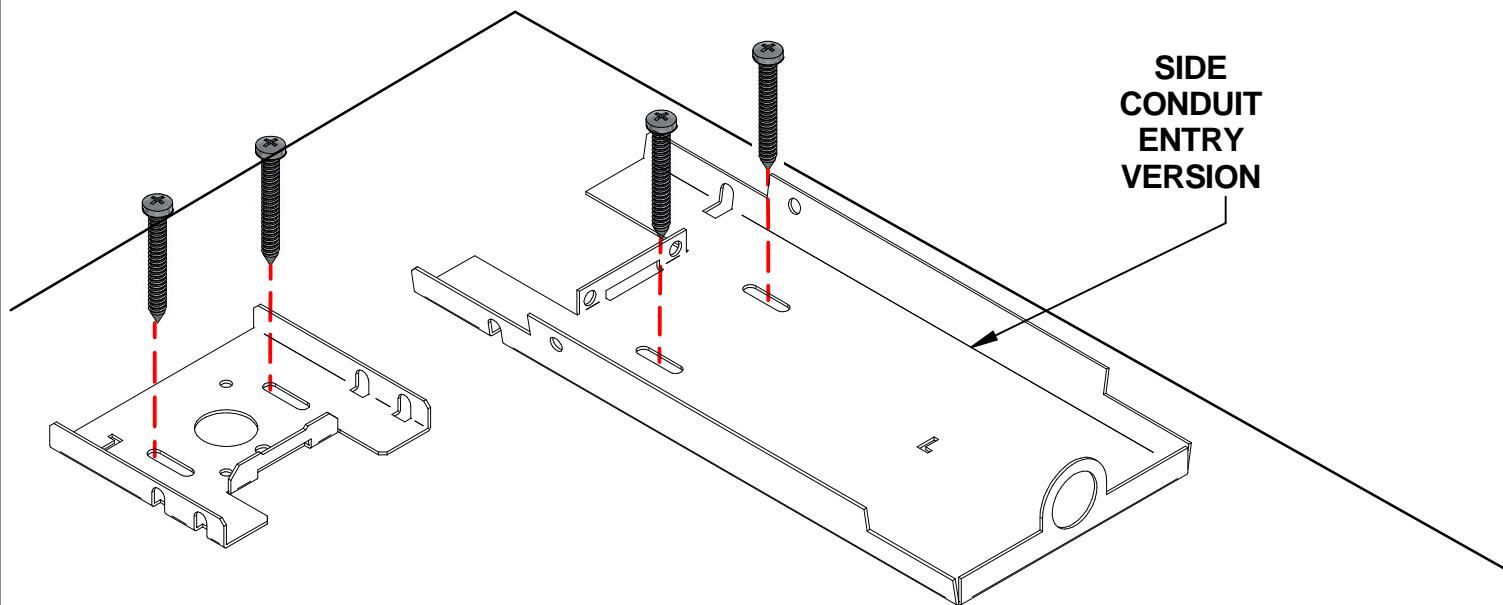

- 4 REMOVE TERMINAL COVER (COVER IS NOT NEEDED FOR SIDE CONDUIT ENTRY)**

UNSCREW

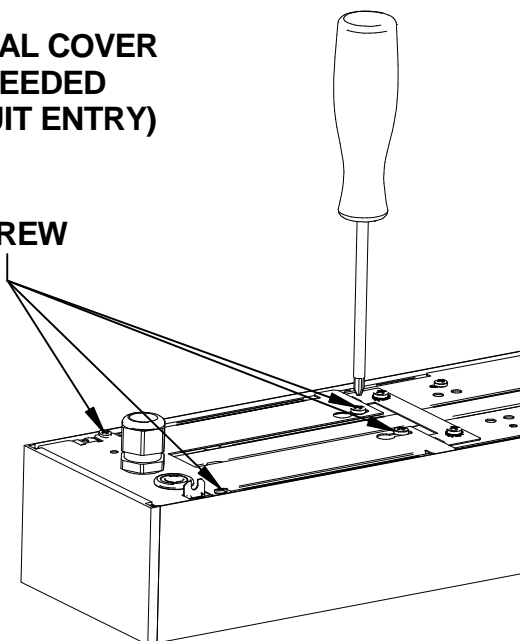

SLIDE AND LIFT THROUGH KEYSLOTS

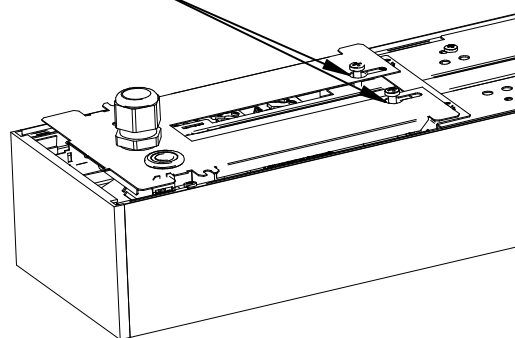

FOR SUSPENDED FITTINGS REMOVE DOG HOOKS, SNIP CABLES AND TUCK NEATLY INTO FITTING

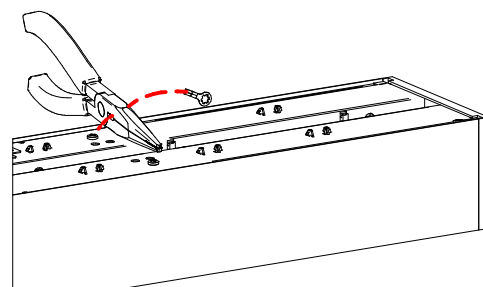
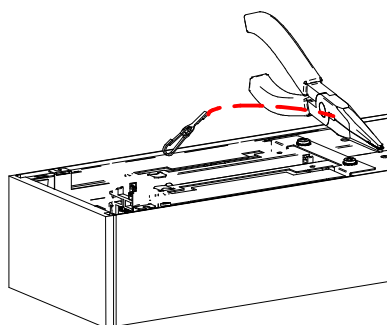

Product Installation Instructions

5 SUSPENDED - SLIDE IN SUSPENSION ENDSTOPS, FOLD TAB AT BOTH ENDS AND SECURE WITH SCREW

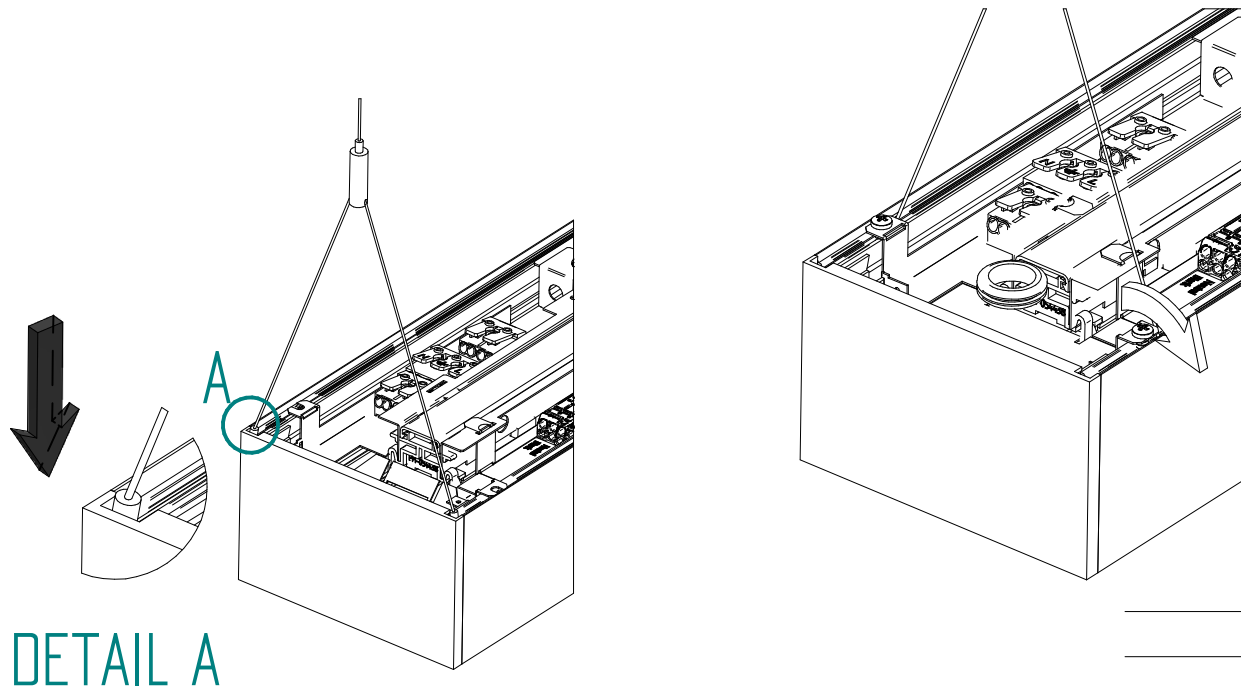

DETAIL A

6 SUSPENSION CAN BE FIXED IN POSITION BY INSERTING A SCREW IN THE EXTRUSION CHANNEL

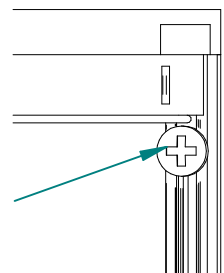

7 SURFACE - PUSH BRACKETS INTO EXTRUSION CHANNELS AT THE HIGHLIGHTED LOCATIONS AND SECURE WITH SCREWS

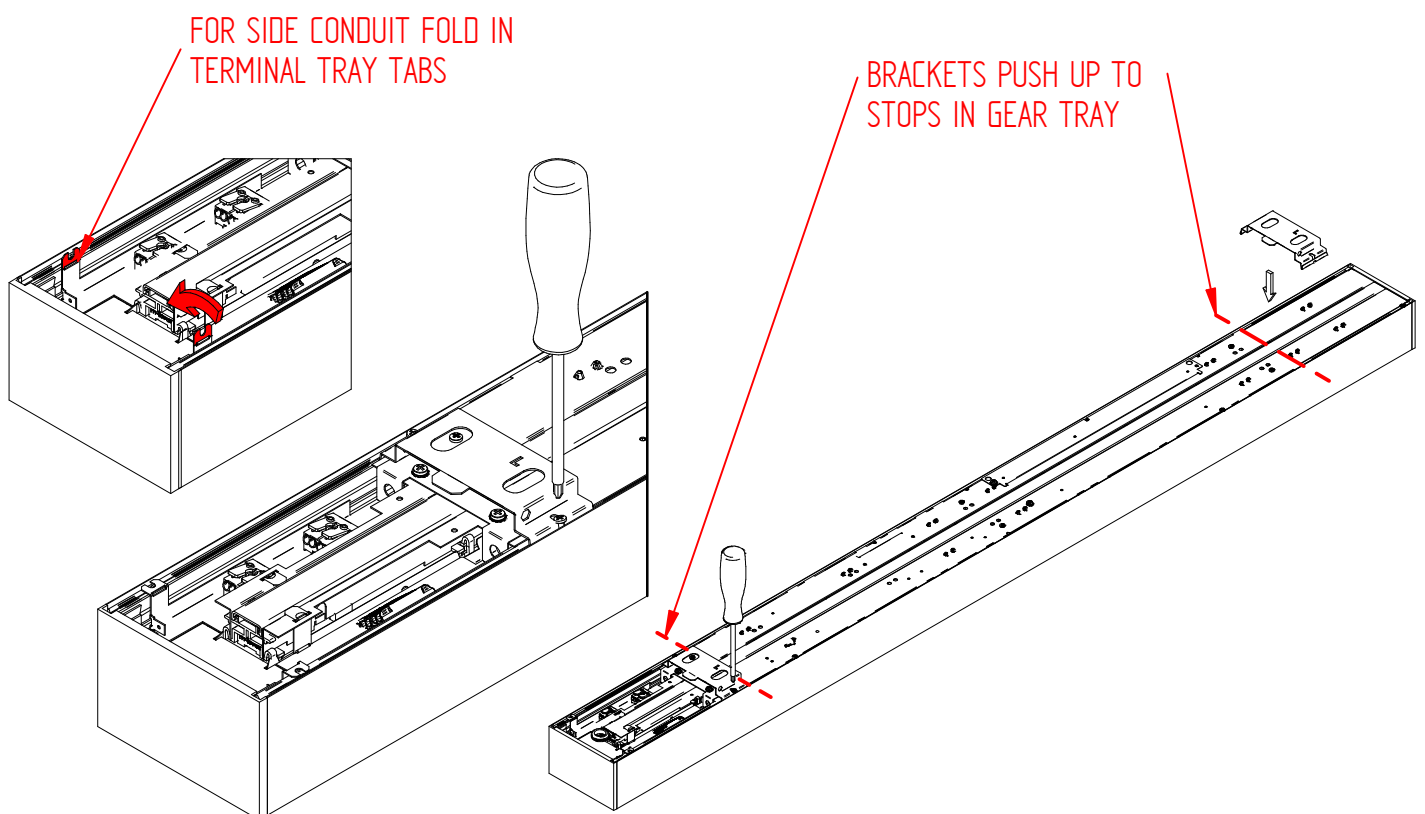

Product Installation Instructions

8 SURFACE - CONNECT INSTALLATION CABLES TO BRACKET

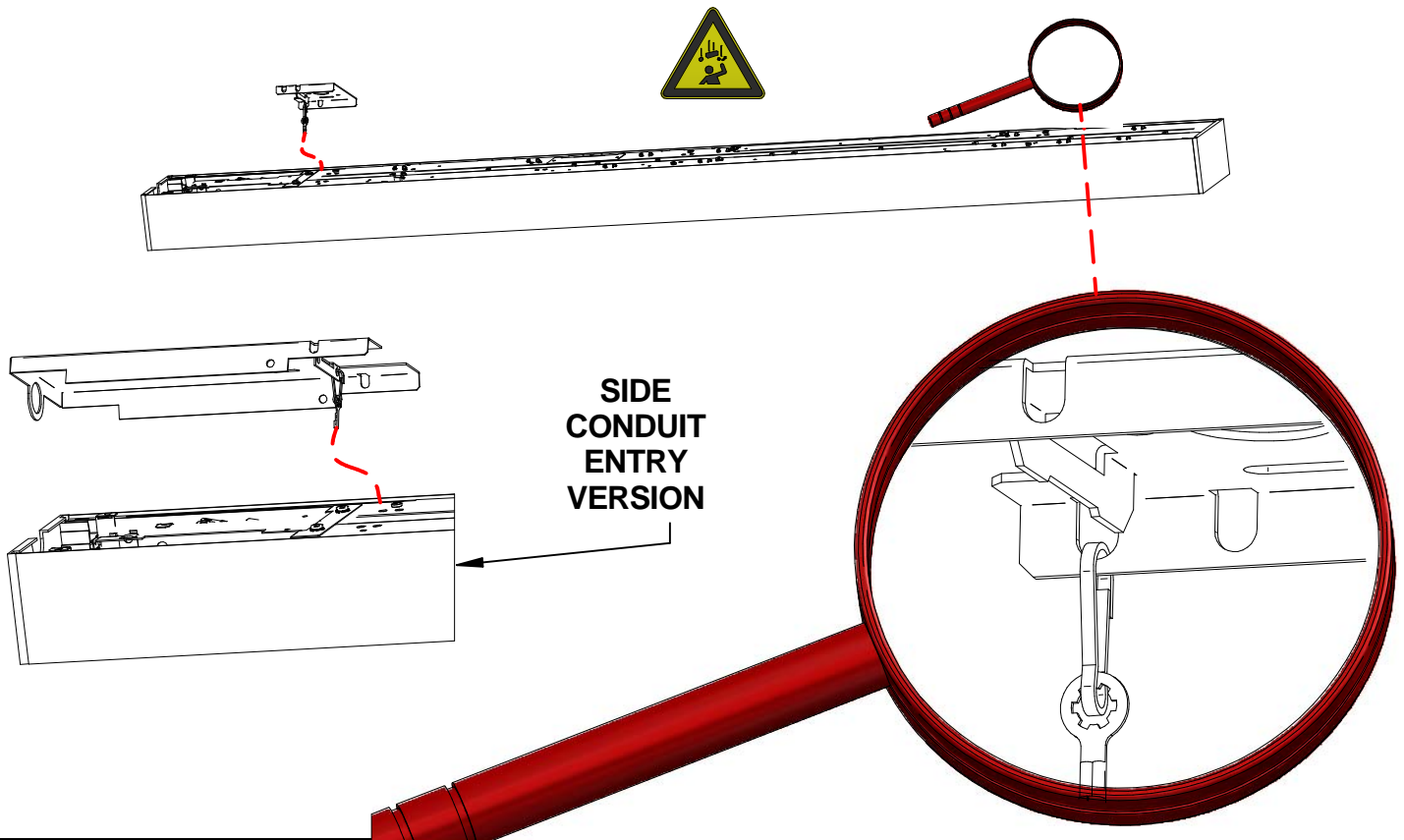

9 FIT GLANDS AND STRAIN RELIEF TO TERMINAL COVER. FEED CABLE THROUGH GLANDS AND STRIP TO REQUIRED LENGTH FOR TERMINAL BLOCKS USED (SEE NEXT STEP).



SUSPENDED STRAIN RELIEF

M16 CABLE ENTRY USED FOR ADDITION CABLES IF REQUIRED

SIDE ENTRY - NO STRAIN RELIEF

CABLE TIE FOR EASIER MANAGEMENT

SURFACE STRAIN RELIEF

TRIM OUTER INSULATION BACK TO JUST BELOW STRAIN RELIEF

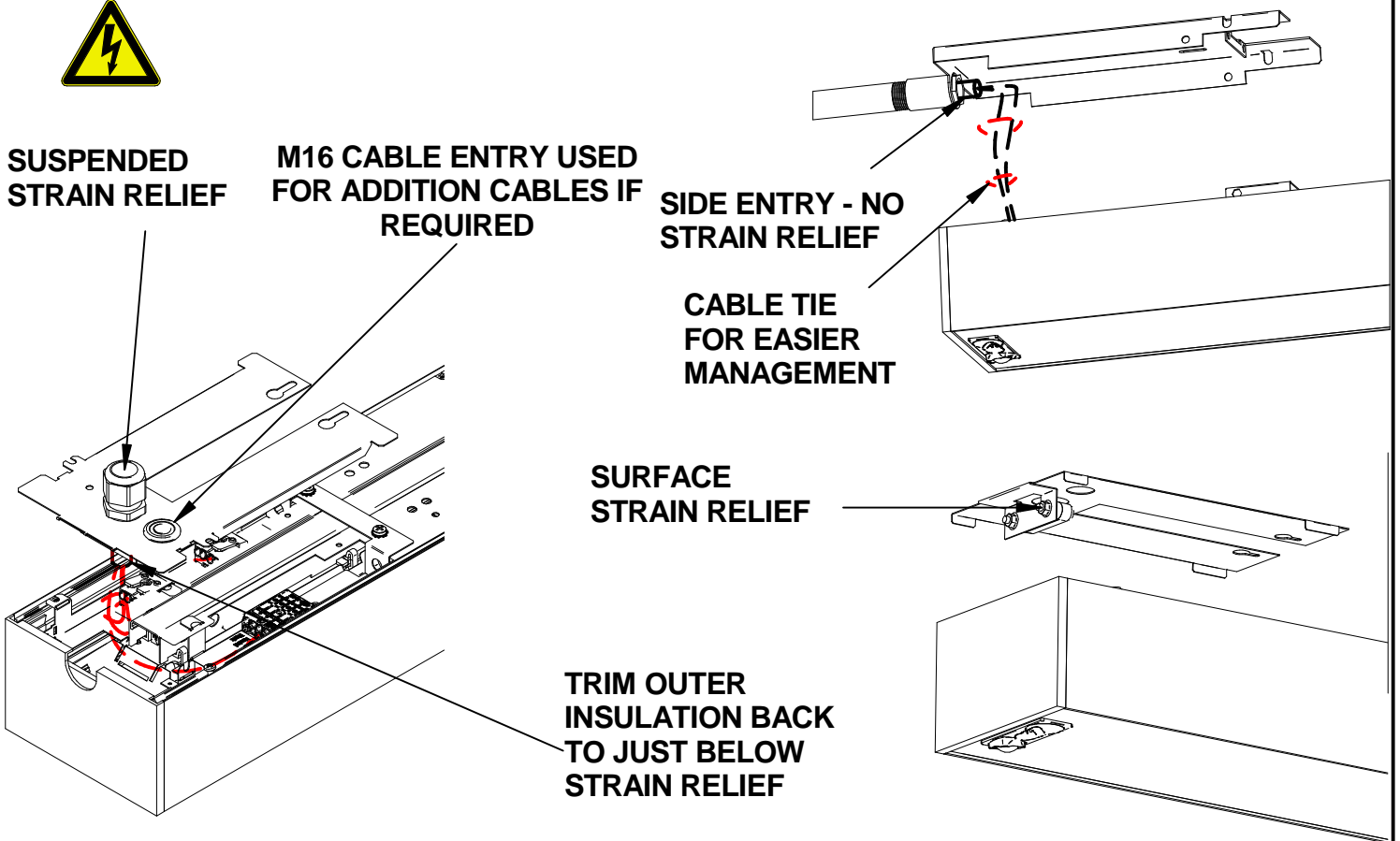

10 WIRE TERMINALS. ONCE WIRED TO TERMINALS TUCK CABLES INTO TERMINAL TRAY AND TIGHTEN STRAIN RELIEF AROUND DOUBLE INSULATED FLEX.

DALI

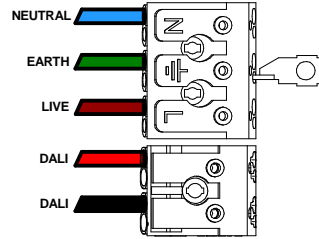

DALI & 3HR EMERGENCY

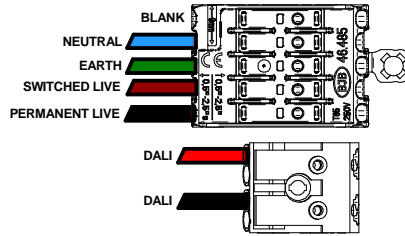

DALI & DALI EMERGENCY

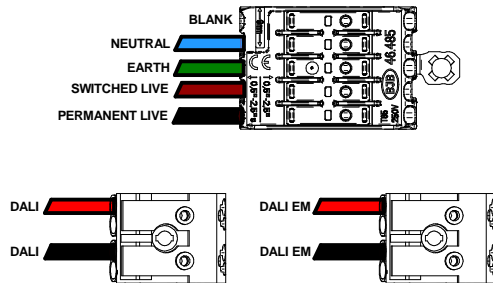

DALI & DALI EMERGENCY WITH DALI LINKS

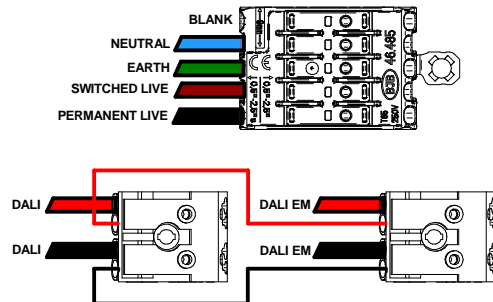

Product Installation Instructions

11 CONNECT BATTERIES

- a. OPEN COVER BY REMOVING SCREWS AND WASHERS
- b. CONNECT BATTERY WIRES
- c. REVERSE PROCESS TO REPLACE BATTERY

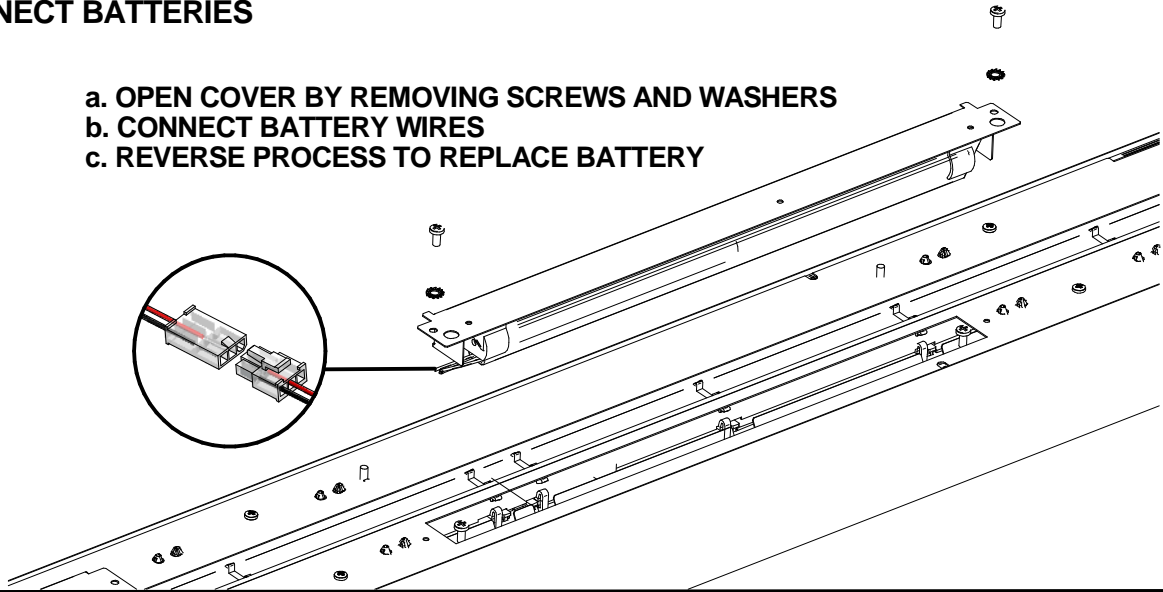

12 SURFACE - SCREW COVER BACK DOWN, RAISE FITTING AND HOOK INTO CEILING BRACKETS FOR SIDE CONDUIT VERSION DON'T USE COVER JUST HOOK INTO BRACKETS

SIDE CONDUIT ENTRY - CONNECT EARTH WIRE BEFORE MOUNTING. BRACKET SLOTS INTO EXTRUSION CHANNEL BEFORE SLOTTING INTO HOOK

PUSH CABLE THROUGH CEILING AS FITTING IS RAISED

BRACKETS HOOK TOGETHER

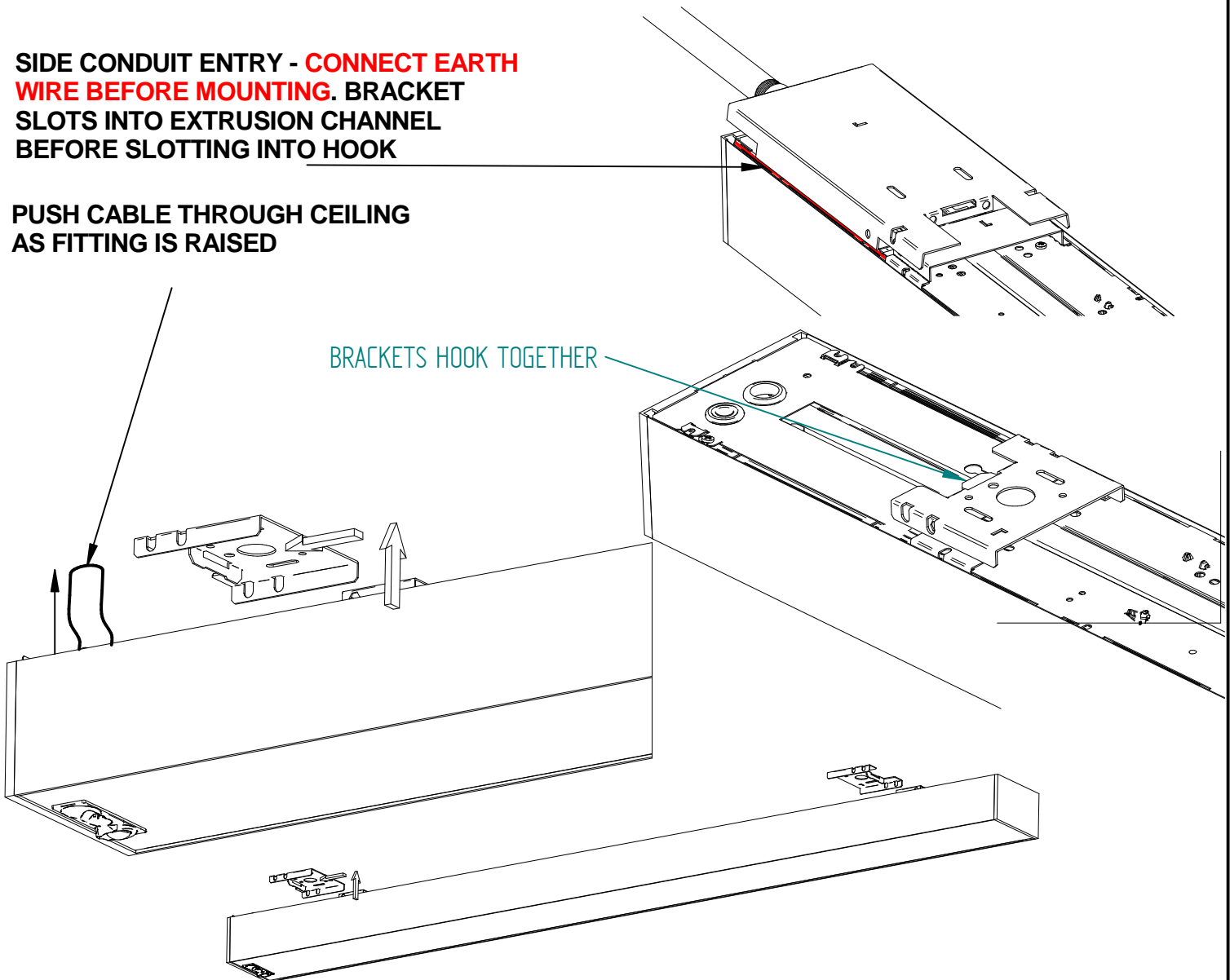

Product Installation Instructions

13 SURFACE - SECURE BRACKETS WITH SCREWS ON BOTH SIDES (4 POINTS)

CHECK INSTALLATION CABLES AREN'T TRAPPED BETWEEN BRACKETS BEFORE SCREWING. THEY CAN BE PULLED OUT OF THE WAY.

AFTER SCREWING BRACKETS TOGETHER PUSH SAFETY CABLES IN SO THEY CAN'T BE SEEN.

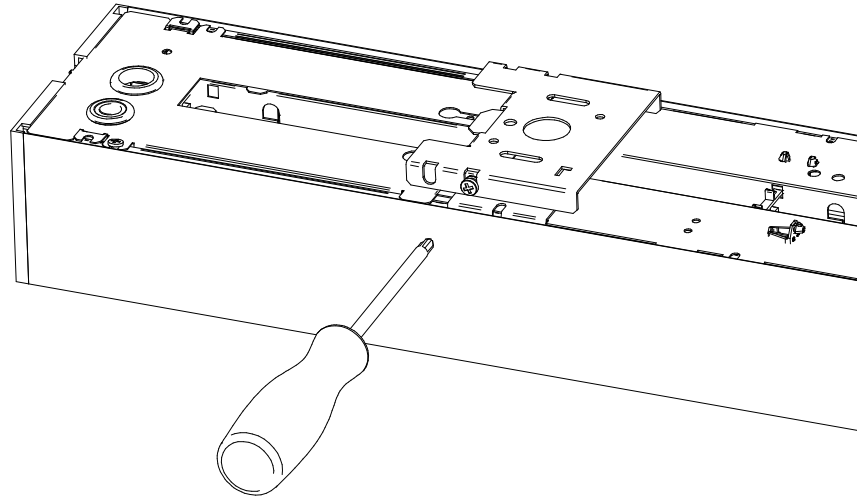

14 SUSPENDED - RE-FIT TERMINAL COVER AND POSITION CABLES. TIGHTEN GLANDS FOR STRAIN RELIEF IF NECESSARY. RE-ATTACH COVER EARTH LEAD.

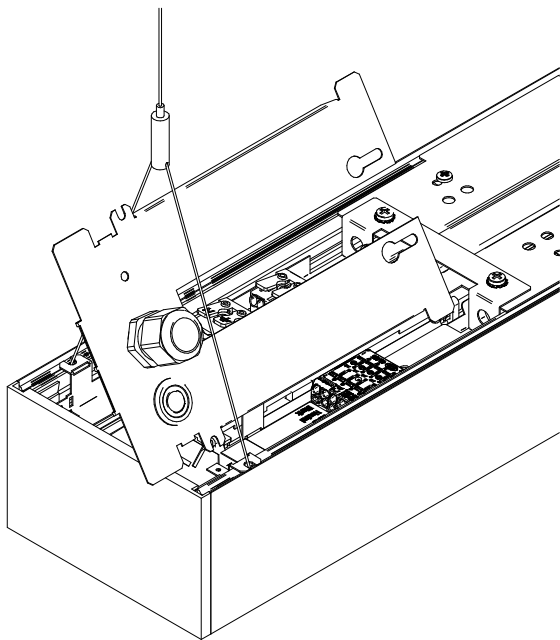

POSITION 1 - FLEXIBLE
(ADD SCREW TO SECURE)

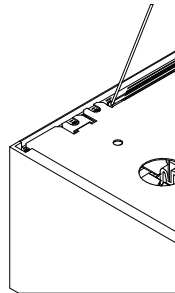

POSITION 2 - INLINE
WITH SUPPLY

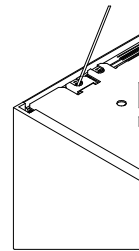

IF TRIMMING EXCESS
WIRE, NOTE THAT
FUTURE ADJUSTMENT
WILL BE RESTRICTED

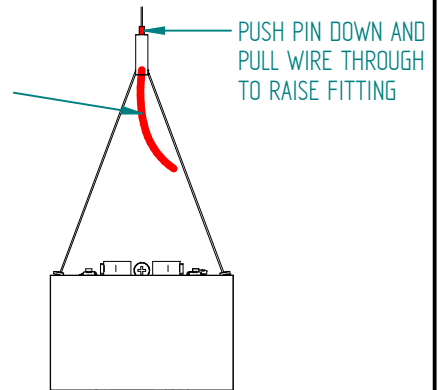

REVERSE STEP 4 TO SECURE TERMINAL COVER WITH SCREWS



SUPPORT WEIGHT OF FITTING WHILST FITTING COVER AND RAISING FITTING